

Stamford 317

Lot 125, Burton Street



G.J. Gardner. HOMES

\$616,627

 **3**  **4**  **3**  **2**

LAND SIZE
760m²

LOT FRONTAGE
17m

LOT DEPTH
36m

House Key Features:

- Built in robes to all bedrooms
- Insulation to ceiling and walls
- Overhead kitchen cupboards
- 2.7 metre ceiling heights
- Security locks to all windows
- 3 Coat paint system
- Resort facade shown

Land Key Features:

- Generous allotment size
- Fully titled
- Ready to build your dream home on
- Elevated position
- Beautiful views over Newenham
- Take advantage of the natural contours of this land
- Split level house designs available for this block

HOUSE PRICE

\$382,777

LAND PRICE

\$233,850

Contact: Ben Walker ben@newenham.com.au
0429 107 497 RLA 63301

Visit our Sales & Info Centre:
164 Flaxley Rd Mt. Barker

Open 12 – 5pm daily
newenham.com.au

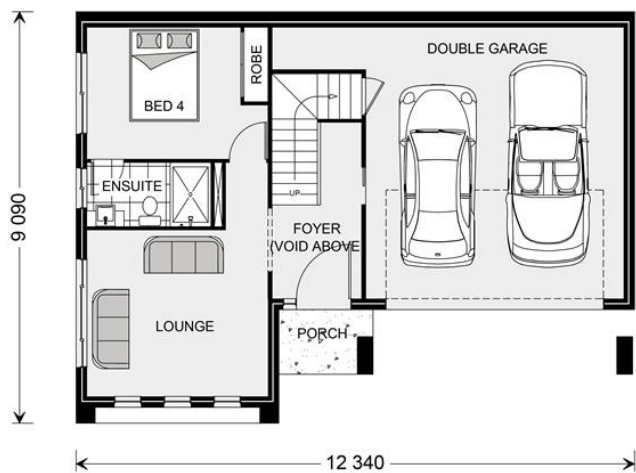

Disclaimer: All care has been taken in the preparation of this material. No responsibility is taken for any errors or omissions. Details are subject to change without notification. Images for illustration purposes only. E&EO.

Contact: Ben Walker ben@newenham.com.au
0429 107 497 RLA 63301

Visit our Sales & Info Centre:
164 Flaxley Rd Mt. Barker

Open 12 – 5pm daily
newenham.com.au